

# DocuCentre S2420 / S2220

Digital Black & White Multifunction Device





# Feature-rich and super-compact. A truly user-friendly multifunction device.



**Increased Productivity**  
Fast processing and 19 second warm-up time, accelerating your work

**Colour Scanning**  
Colour scanning feature, facilitating paperless work

**Easy Operation**  
Control panel with large buttons and simple display

## Copy / Print

<b>S2420</b>	<b>S2220</b>
B/W	B/W
<b>24</b>	<b>22</b>
ppm	ppm

## Scan

Colour	B/W
<b>4</b>	<b>18</b>
ppm	ppm

## Fax

**MAX A3**  
Super  
**G3**  
Compatible



Paper exit : The height of the paper exit slot has been improved, allowing easier access to printed output.

## Useful Features

### Multiple PCs can share the device.

DocuCentre S2420/S2220 comes equipped with an auto-switching, 100BASE-TX/10BASE-T network interface that delivers maximum performance. It supports a variety of LAN environments.

Note: Optional for the CPS model.

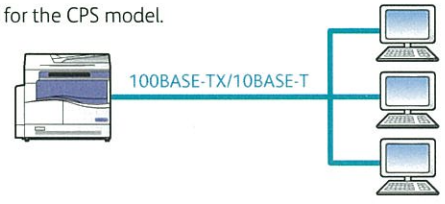

### Network Extension

### Colour scanning can be performed locally or via your office LAN.

Colour scanning can be used not only with Network Scan but also with Local Scan via USB connection. Also, there are many choices how to send the scanned files. This will accelerate digitalization of office works.

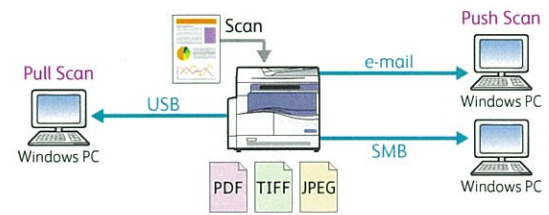

### Scan

### ID Card Copy is very easy-to-use.

Both front and back sides of ID Card can be laid side-by-side on one side of the copied output. Guidance screen showing how to place ID Card can prevent failure.

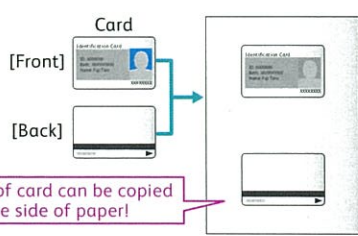

Both sides of card can be copied on one side of paper!

### ID Card Copy

### Both collating works can be done easily.

The Rotating Collate function can be used to assemble printed output by loading the same size paper into two tiered trays (Portrait and Landscape) or into either Portrait or Landscape tray and Bypass Tray.

\* To use the Rotating Collate function, the same size paper must be loaded in both Portrait and Landscape trays.

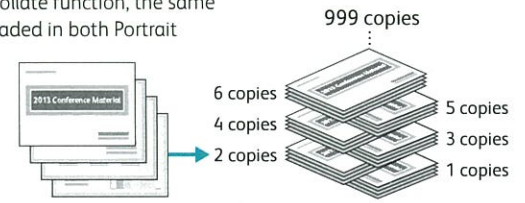

### Collate (Rotate)



## Adopting Quick-Buttons Offers Easier and Simpler Operations.

The diagram shows the control panel of the DocuCentre S2420/S2220 with several callouts explaining the benefits of the quick-buttons:

- Immediate access to ID Card Copy:** Points to the ID Card Copy button.
- A quick grasp of information on Quick-Buttons:** Points to the Copy button.
- A quick monitoring and configuration change:** Points to the Speed Dial button.
- Service Button:** Points to the Service button.
- Quick-Button:** Points to the Quick-Buttons (Lighten/Darken, Original Type, 2 Sided, Collated/Resolution) and explains: "Allows you to quickly select frequently-used copy/scan functions".
- Address Book Button:** Points to the Address Book button and explains: "Allows you to switch even from the 'Copy'/'ID Card Copy' screen to Scan Service where destinations are listed".
- The indicator light turns on when the machine gets ready to start the operation:** Points to the Start button.

## Environmental Performance

### Reusing toner

Waste toner is collected for recycling. A waste toner bottle is now no more needed because the collected toner is reused by means of this ecofriendly system, making no waste.

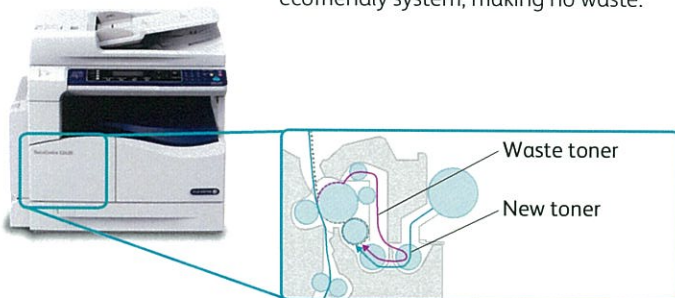

### Saving energy and cost

DocuCentre S2420/S2220 has realized the power consumption (TEC value\*) of 1.46kWh. DocuCentre S2420/S2220 also complies with strict standards of International ENERGY STAR Program. The design of the machine offers an ability not only to care for the environment but also save user cost.

\* Method to calculate power consumption based on the assumption of actual usage defined by International ENERGY STAR Program (power consumption per week)

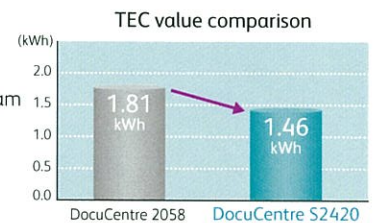

## Optional accessories



1 Fax Kit  
[EL201055]

2 One-tray Module  
[EL201057]

3 Two-tray Module  
[EC102050]

4 Stand  
[EL200737]

5 Tray Lock  
[EL201058]

Note: Padlock must be purchased separately.



# DocuCentre S2420 / S2220 Specifications

## Basic Specifications / Copy Function

Item	DocuCentre S2420	DocuCentre S2220
Type	Desktop Type	
Memory	256MB	
Hard Disk Capacity	NA	
Colour Capability	NA	
Scanning Resolution	600 x 600dpi	
Printing Resolution	600 x 600dpi (Text/Text-Photo/Photo)	
Half-tone/Printable Colours	256 shades of Gray scales	
Warm-up Time	19 seconds or less (at room temperature 20°C)	
Original Paper Size	Max. 297x432mm (A3, 11x17") for both sheet original and book original	
Output Paper Size	Max	Tray: A3, 11x17", Bypass Tray: A3, 11x17"
	Min	Tray: A5, Bypass Tray: A5
Output Paper Weight*1	Image loss	Lead Edge: within 5.5mm, Trail Edge: within 6mm, Right & Left Edges: within 5.5mm
	Tray1	60 to 90gsm
	Tray2-4 (Option)	60 to 216gsm
	Bypass Tray	60 to 216gsm
First Copy Output Time	7.2 seconds or less (A4LEF)	
Reduction/Enlargement	Size-to-Size	1:1+/- 0.8%
	Preset	1:0.50, 1:0.70, 1:0.81, 1:0.86, 1:1.00, 1:1.15, 1:1.22, 1:1.41, 1:2.00
	Variable	1:0.25 - 1:4.00 (in 1% increments)
Continuous Copy Speed*2*3	A4LEF/B5LEF	24 ppm, Duplex: 17 ppm
	A4	15 ppm, Duplex: 8.7 ppm
	B5	12 ppm, Duplex: 7.2 ppm
	B4	12 ppm, Duplex: 7.9 ppm
	A3	12 ppm, Duplex: 8.6 ppm
Paper Tray Capacity	Standard	Tray1: 250 sheets*4, Bypass tray: 100 sheets*5
	Option	One Tray Module (Tray 2): 500 sheets, Two Tray Module (Tray 3 and 4): 500 sheets each*4
	Max	1,850 sheets (Tray 1 + Tray 2 + Tray 3 + Tray 4 + Bypass Tray)
Continuous Copy*5	999 sheets	
Output Tray Capacity*4	250 sheets (A4LEF)	
Power Supply	AC220-240V ± 10%, 10A for 50/60Hz ± 3%	
Power Consumption	1.0 kW or less, Sleep mode: 2.3 W or less	
Dimensions*7	W 595 x D 573 x H 495 mm (With Platen Cover), W 595 x D 573 x H 580 mm (With DADF)	
Weight*8	31 kg (With Platen Cover), 37 kg (With DADF)	
Space Requirement	W 947 x D 573 mm (With Platen Cover, with Bypass Tray fully extended)	
	W 947 x D 573 mm (With DADF, with Bypass Tray fully extended)	

\*1: Use of Fuji Xerox brand paper is recommended. Copying may not be performed correctly depending on the conditions. \*2: The speed may be reduced due to image quality adjustment. These are the speeds used for Bond, Plain, and Recycled paper. Print performance can be varied depending on the type of paper used. \*3: The speed of the first set for 2-sided copy with the document feeder may be reduced to 13ppm. \*4: When using 80gsm Paper. \*5: When using Fuji Xerox Standard Paper. \*6: The machine may pause temporarily to perform image stabilization. \*7: Except power cord. Width include power cord: 622mm (w/ Platen Cover). \*8: Toner cartridge is not included.

## Print Function

Item	Description	
Type	Built-in Type	
Output Paper Size	Same as the Basic Specifications / Copy Function	
Continuous Print Speed*1	Same as the Basic Specifications / Copy Function	
Print Resolution	Output Resolution	600 x 600dpi
	Data Process Resolution	600 x 600dpi
PDL	Standard HBPL (Host Based Print Language)	
Protocol	Standard Network connection: TCP/IP v4/v6 (lpd, Port9100)	
Operating System*2	Windows® XP (32bit), Windows Server® 2003 (32bit), Windows Vista® (32bit), Windows Server® 2008 (32bit), Windows® 7 (32bit), Windows® 8 (32bit), Windows® XP (64bit), Windows Server® 2003 (64bit), Windows Vista® (64bit), Windows Server® 2008 (64bit), Windows® 7 (64bit), Windows® 8 (64bit), Windows Server® 2008 R2 (64bit), Windows Server® 2012 (64bit)	
Connectivity	Standard USB2.0, Ethernet 100BASE-TX/10BASE-T	

\*1: The speed may be reduced due to image quality adjustment. Print speed may also drop depending on the documents. \*2: Please refer to the Fuji Xerox web site for the latest supported operating systems.

### Notes

- If a problem occurs with the recording medium in the device, received data, stored data, and data registered in the settings, etc. may be lost. Please note that Fuji Xerox will not be held responsible for any damages resulting due to lost data.
- The minimum holding period for replacement precision parts is 7 years after production is ceased for the main unit of the device.

### Reproduction Prohibitions

Please note that reproduction of the following is prohibited by law: Domestic and overseas bank notes and coins, government-issued securities, national bonds and local bond certificates. Unused postage stamps and post cards. Certificate stamps stipulated by law. The reproduction of works for copyright purposes (literary works, musical works, paintings, engravings, maps, cinematographic works, photographic works, etc.) is prohibited except when they are reproduced personally, at home or within limited range according to the above. This product is equipped with an anti-counterfeit feature. This feature is not intended to prevent illegal reproduction. Be extremely careful about the management of equipment used.

Descriptions in this material, product specifications and / or appearances are subject to change without prior notice due to improvements. Please note that the product colour appears differently from the actual colour as a result of properties of papers or printing ink. Windows is registered trademarks of Microsoft Corporation. Other company names or product names are registered trademarks or trademarks of each company.

## Scan Function

Item	Description	
Type	Colour Scanner	
Original Paper Size	Same as the Basic Specifications / Copy function	
Scanning Resolution	Monochrome: 600 x 600dpi, 400 x 400dpi, 300 x 300dpi, 200 x 200dpi Colour: 300 x 300dpi, 200 x 200dpi	
Scanning Halftone	Colour: 8-bits input / 8-bits output for each RGB Colour, Monochrome: 1-bit input / 1-bit output	
Scanning Speed*1	BW: 18 ppm, Colour: 4 ppm [Fuji Xerox Standard Document(A4LEF), 200dpi, using TWAIN driver (USB)]	
Connectivity	Standard	USB 1.1/2.0, Ethernet 100BASE-TX/10BASE-T
	Driver	TWAIN / WIA*2
Scan to PC*4	Operating System*3	Windows® XP (32bit), Windows Server® 2003 (32bit), Windows Vista® (32bit), Windows Server® 2008 (32bit), Windows® 7 (32bit), Windows® 8 (32bit), Windows® XP (64bit), Windows Server® 2003 (64bit), Windows Vista® (64bit), Windows Server® 2008 (64bit), Windows® 7 (64bit), Windows® 8 (64bit), Windows Server® 2008 R2 (64bit), Windows Server® 2012 (64bit)

\*1: The scanning speed varies depending to documents. \*2: WIA stands for Windows Image Acquisition. \*3: Please refer to the Fuji Xerox web site for the latest supported operating systems. \*4: TWAIN/WIA via USB. Note: TWAIN application or WIA application is necessary to use Local Scan function. Format of the file after scanning depends on each application.

## Network Scan Function

Item	Description	
Type	Colour Scanner	
Original Paper Size	Same as the Copy function	
Scanning Resolution	Monochrome: 600 x 600dpi, 400 x 400dpi, 300 x 300dpi, 200 x 200dpi Colour: 300 x 300dpi, 200 x 200dpi	
Scanning Halftone	Colour: 8-bits input / 8-bits output for each RGB Colour, Monochrome: 1-bit input / 1-bit output	
Scanning Speed*1	BW: 18 ppm, Colour: 4 ppm [Fuji Xerox Standard Document (A4LEF), 200 dpi]	
Connectivity	Ethernet 100BASE-TX/10BASE-T	
Scan to PC*3	Protocol	TCP/IP (SMB)
	Operating System*2	Windows® XP (32bit), Windows Server® 2003 (32bit), Windows Vista® (32bit), Windows Server® 2008 (32bit), Windows® 7 (32bit), Windows® 8 (32bit), Windows® XP (64bit), Windows Server® 2003 (64bit), Windows Vista® (64bit), Windows Server® 2008 (64bit), Windows® 7 (64bit), Windows® 8 (64bit), Windows Server® 2008 R2 (64bit), Windows Server® 2012 (64bit)
Scan to e-mail	File Format	Monochrome binary: PDF/TIFF(Multi-Page), Colour: PDF(Multi-Page)/JPEG
	Protocol	TCP/IP (SMTP Authentication)
File Format	Protocol	TCP/IP (SMTP Authentication)
	File Format	Monochrome binary: PDF/TIFF(Multi-Page), Colour: PDF(Multi-Page)/JPEG

\*1: The scanning speed varies depending to documents. \*2: Please refer to the Fuji Xerox web site for the latest supported operating systems. \*3: Network Push Scanning.

## Fax Function (Option)

Item	Description	
Send Document Size	Max A3	
Recording Paper Size	Max A3, Min A4	
Transmission Time*	3 seconds range	
Transmission Mode	Super G3 / G3 ECM / G3 (ITU-T)	
Scanning Resolution	Standard	8 x 3.85 lines/mm, 200 x 100dpi
	Fine	8 x 7.7 lines/mm, 200 x 200dpi
Super Fine (400dpi)	16 x 15.4 lines/mm, 400 x 400dpi	
Coding Method	MH, MR, MMR, JBIG	
Transmission Speed	G3: 33.6/31.2/28.8/26.4/24.0/21.6/19.2/16.8/14.4/12.0/9.6/7.2/4.8/2.4kbps	
Applicable Lines	PSTN / PBX, 1port	

\*: When A4 size document with approximately 700 characters is transmitted in standard image-quality (8x3.85 lines/mm) and in high-speed mode (28.8kbps or faster, JBIG). Only indicates the time for transmitting the image information and does not include the communication control time. The total communication time will vary depending on the contents of the document, the type of machine receiving the fax, and line condition.

## Duplex Automatic Document Feeder

Item	DocuCentre S2420	DocuCentre S2220
Type	Duplex Automatic Document Feeder	
Original Paper Size / Paper Weight	Max: A3, 11 x 17", Min: A5, 38-128gsm (2 Sided: 50-128gsm)	
Capacity*	110 sheets	
Feeding Speed (A4LEF)	24 ppm (A4LEF, 1 Sided),	22 ppm (A4LEF, 1 Sided),
	13 ppm (A4LEF, 2 Sided)	13 ppm (A4LEF, 2 Sided)
Dimensions/Weight	Dimensions: W 540 x D 492 x H 115mm, Machine Weight: 7kg	

\*: When using 80gsm Paper.

## Duplex Kit

Item	Description
Paper Size	Max: A3, 11 x 17", Min: A5, B5LEF
Paper Weight*	60 to 90gsm (91-110gsm support Bypass Tray)

\*: Use the Bypass tray when using 91-110gsm Paper.



### For Your Safe Use

Before using the product, read the Instruction Manual carefully for proper use. Use the product with an appropriate adequate power source and voltage displayed. Be sure to establish a ground. In the case of a failure or short circuit, an electric shock may result.



For more information or detailed product specification, please call or visit us at

## Fuji Xerox Vietnam Company Limited

4A Floor, Vincom Center  
72 Le Thanh Ton, District 1, Ho Chi Minh City  
Tel: (84-8) 38 290 038 FAX: (84-8) 38 290 032

<http://www.fujixerox.com.vn>

## Ha Noi Branch

8<sup>th</sup> Floor, Sun Red River Building  
23 Phan Chu Trinh, Hoan Kiem District, Ha Noi City  
Tel: (84-4) 38 241 063 FAX: (84-4) 38 241 113